

# REIDBRACE BRACING SYSTEM

## DESCRIPTION

Reidbrace™ is rapidly becoming the preferred option for tension tie bracing and provides an economic off-the-shelf solution for bracing structures, tie-back applications and temporary bracing.

## FEATURES

- Eliminates expensive threaded rods. Reidbrace™ uses seismic grade 500E Reidbar™ for tendons.
- Eliminates welding and threading. Reidbar™ is available in either black or galvanised bar in standard 6 metre lengths and can be joined using standard couplers and locking nuts. (Longer Reidbar™ lengths by order).
- Over length bar can be cut without dismantling the bracing assembly.
- Substantial cost savings in labour and materials.
- All components sold as kits or separately.
- Engineered design - tested and certified to exceed the yield capacity of the 500E grade Reidbar™ (with the exception of RBRACE32, refer to Table1.)
- Designed to fit over structural steel flanges or cleats to provide double shear connection. The bracket thickness will influence the strength of system. Refer to Reid for design advice.
- Supplied with pin and clip for connection to structure - no need to source separate HS bolt.
- Reidbrace is galvanised for added corrosion protection.

## APPLICATIONS

- Wall and roof bracing
- Retro fitted seismic bracing
- Retaining wall tie backs
- Cross ties
- Temporary Bracing
- Beam Strengthening

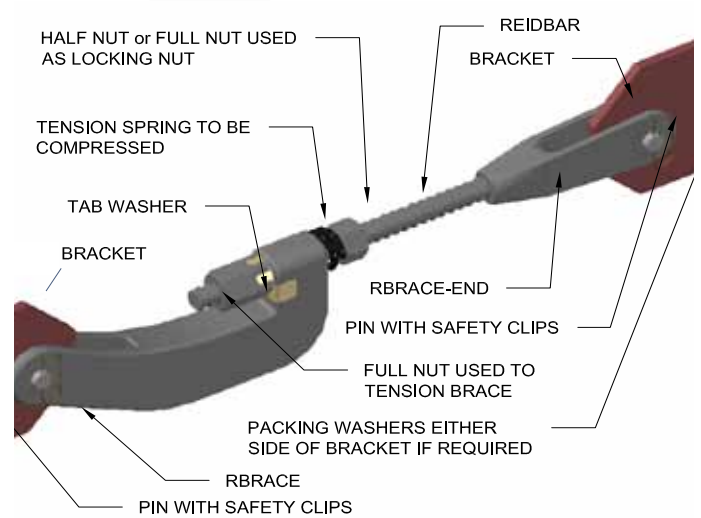
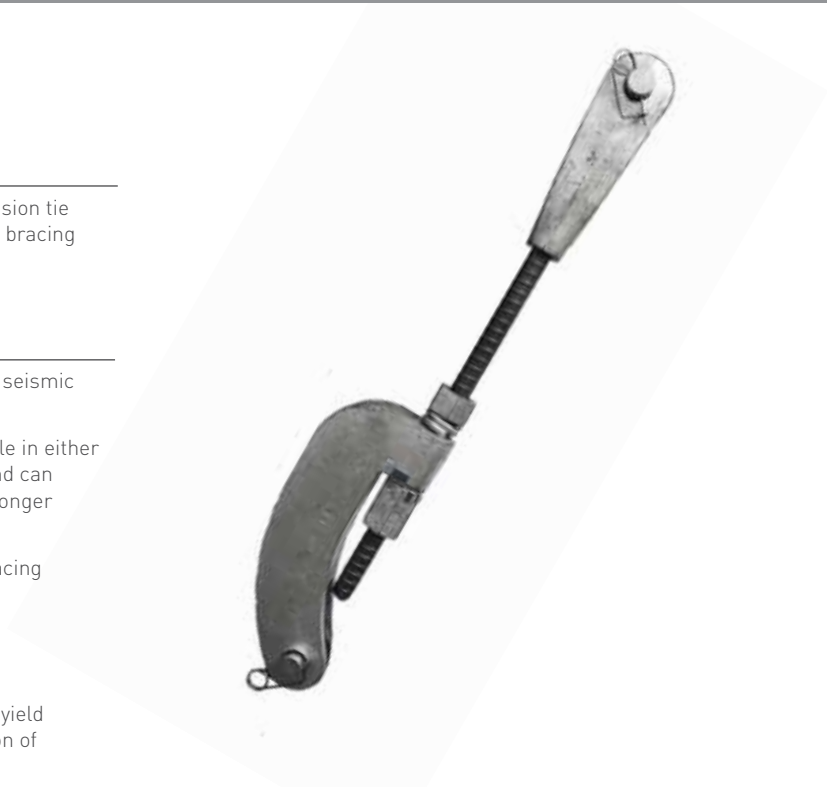

## REIDBRACE KITS & PRODUCT CODES

The Reidbrace Kits comprise of six major components and includes all the pins and safety clips for ease of ordering and installation. The kits are available in 12, 16, 20, 25 and 32mm sizes.



Bar Size	Kit Code (includes all fittings including pins)
12mm	RBRACE12-SET
16mm	RBRACE16-SET
20mm	RBRACE20-SET
25mm	RBRACE25-SET
32mm	RBRACE32-SET

## REIDBRACE SPECIFICATION

Table 1: CHARACTERISTIC STRENGTHS - min ultimate strength in kN

RBRACE Size	RBRACE Banana	RBRACE End	Reidbar FULL NUT	Reidbar HALF NUT	Min Yield	Reidbar Min UTS
12mm	>116	>65	79	34	56.5	65.0
16mm	>116	>116	141	60	100.6	115.6
20mm	>181	>181	220	94	157.0	180.6
25mm	>282	>282	344	147	245.5	282.3
32mm	>430	>462	462	241	402.0	462.3

Table 2: PRODUCT SPECIFICATION - DIMENSIONS OF RBRACE BANANA AND RBRACE END

Reidbrace Banana										
Size	A	B	C	D1	D2	D3	E	H	W1	W2
12/16	276	36	46	17	25	19	-	107	16	20
20	345	45	58	21	32	24	-	134	21	25
25	382	53	73	31	40	29	-	149	26	29
32	436	68	72	31	44	38	-	170	36	36

RB-End										
Size	A	B	C	D1	D2	Pin $\phi$	E	H	W1	W2
12	145	32	50	17	-	16	50	40	16	-
16	160	36	55	17	30	16	67	50	16	-
20	195	45	60	21	35	20	88	60	21	-
25	247	50	80	31	43	30	108	80	26	-
32	265	62	85	31	55	30	120	88	32	-

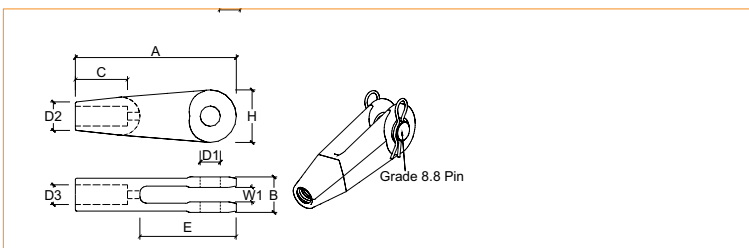
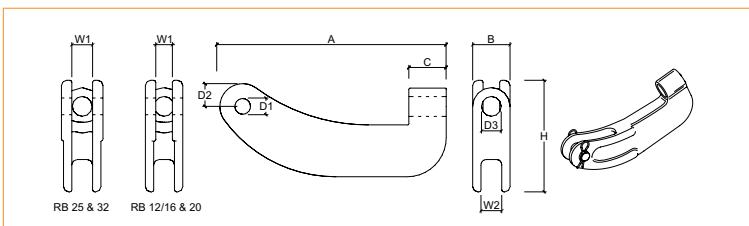

### INSTALLATION SPECIAL CAUTION:

The Reidbrace must be centralised on the bracket to ensure central loading forces.

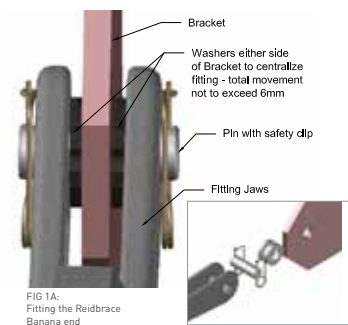

FIG 1A: Fitting the Reidbrace Banana end

FIG 1B: Install of washers when packing is required.

For further technical information and CAD drawings, please refer to the Reid website [www.reids.co.nz](http://www.reids.co.nz) or call 0800 88 22 12. All specification information is also contained in the Reidbar Technical Catalogue.

Ph 0800 88 22 12 | [www.reids.co.nz](http://www.reids.co.nz)

